



ganmartebi Ti baraTi

saxel mwi fo Sesyi dvebis Sesaxeb xel Sekrul ebi s (#360 20 oqtomberi 2014 q.) safuZvel ze da xel Sekrul ebi T gaTval iswinebul i momsaxurebis aRweraSi mocemul i teqnikuri dokumentaciis CamonaTval is mi xedvi T Sedgenil i iqna q. quTaisSi. qal aq quTais municipal itetis meriis Senobis (rusTavel is #3) kibi sa da baqnis arsebul Ri a terasaze pandusis mowyobis samSenebl o dokumentis saproeqto-saxarj TaRri cxvo dokumentaci a.

proeqti iTval iswinebs meriis administraciul i Senobis mTavari Sesavli el i kibi s safexurebis marjvena mxares arsebul i grani tis masiuri moxsnas mTli anad, amasTanave qvafenil is oTxkuTxa fil ebis nawil is aRebas SesaZl ebl obis fargl ebSi dauzianebl ad, ris Semdgom gaWriil iqnes tranSel, masSi qarqil is da betonis daWriil kedl is mosawyobad.

Daxriil obis mi sacemad mSenebl obis aTvis pirvel fenad aRebul ia qvi Sa RorRis fena sil iT, masze Termul ad damuSavebul i xaoiani grani tis fil ebis moki rwl iT.

Sayrdeni kedl ebis sami ve mxare daFarul i iqnes aseve Termul ad damuSavebul i grani tis fil ebi T, xol o pandusis gverdi Ta qimis yovel erT metrSi betonis fenaSi damagrdes moajiris damWeri detail, romel zec Semdgom damagrdes al uminis monikel ebul i moajiri.

Qimis mopi rkeTeba moxdes grani tis Termul ad damuSavebul i fil ebi T, xol o maTi gadabmis adgil i iqnes yovel erT metrSi.

- _ pandusis qanobi 10%
- _ pandusis dasawyi sSi da bol oSi moedani 1.5X1.5 m.
- _ moajiris simaRl e savali nawil idan 0.9 metri simaRl eze
- _ grZivi Rero 0.7 metr simaRl eze (SesaZl oa 0.5 metrze)
- _ saxel urad aRebul ia mil ikvadratebi 40X40X2 mm-ze
- _ moajiris sigrZe pandusis sigrZesTan Sefardebi T aRebul ia 0.3 metri T meti momrgval ebul i radiusi T
- _ moajiri SeiRebos kontrastul i ferebi T

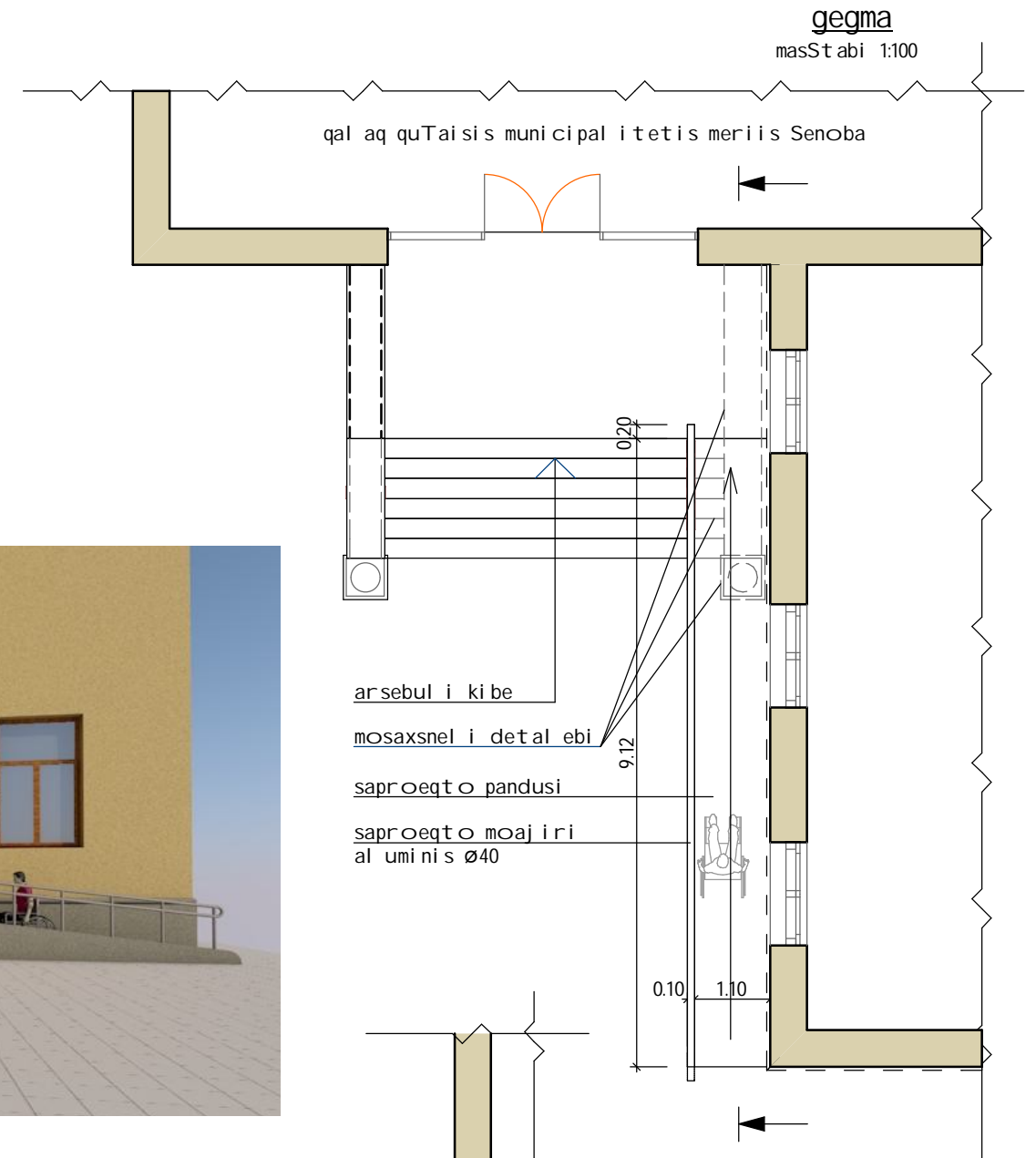

Wriili
masStabi 1:100

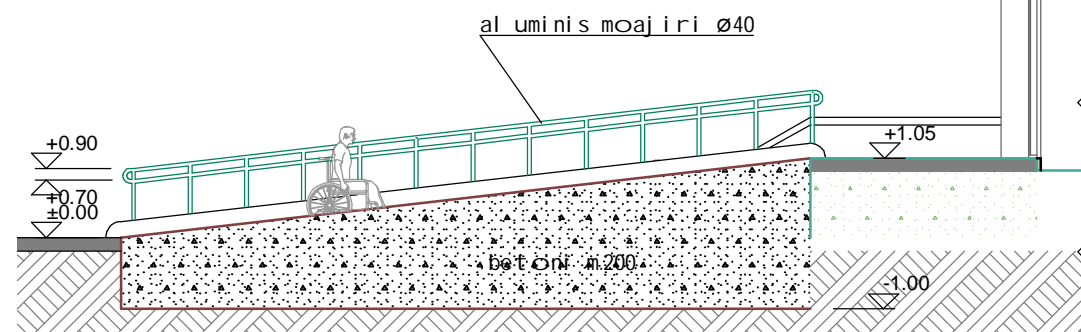

Seni Svna:

1. mSenebl obis dawyebamde konsul tacia gavliil iqnes proeqtis avtorTan.
2. saZirkvl is CaRrmaveba dadgndes adgil ze gruntis gaSi Svl ebis dros proeqtis avtorTan erTad.

	direqtori		r. sal daZe	Sps 'pra impl asti"	qal aq quTais municipal itetis meriis (rusTavel is gamz. #3)
	pr. avtori		r. sal daZe	pandusebis mowyoba	
	daamuSava		gr. yufaraZe		furc. a-1

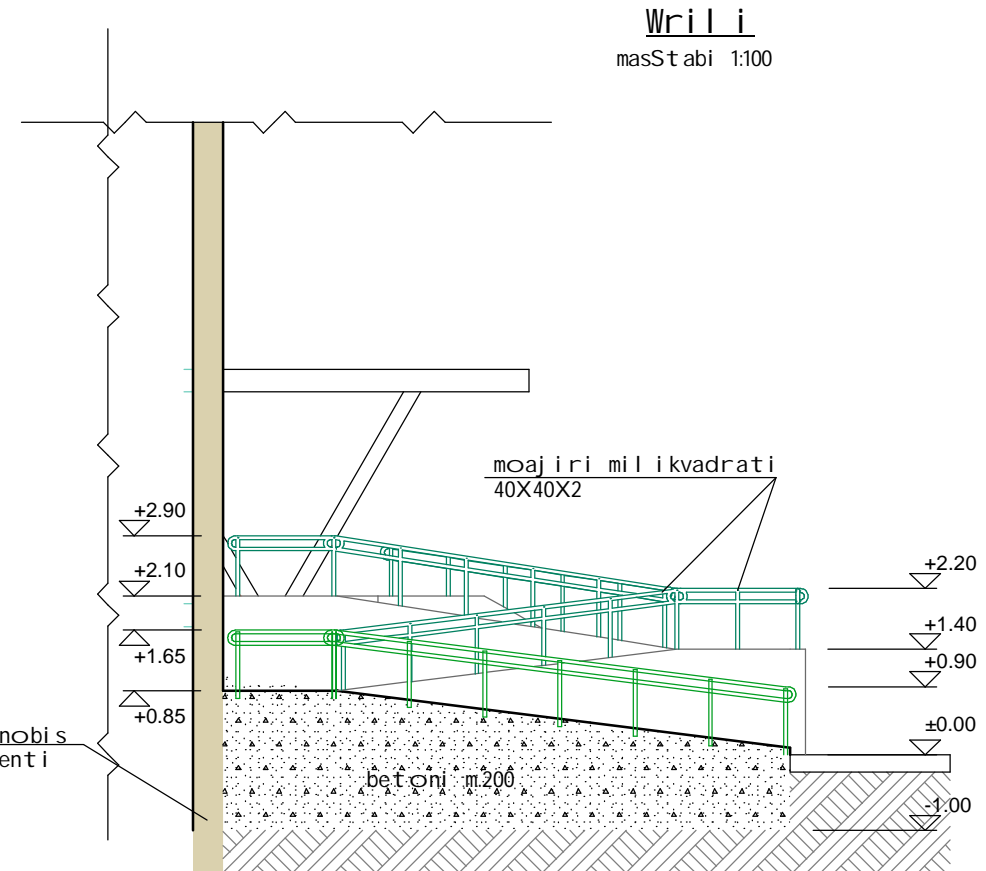
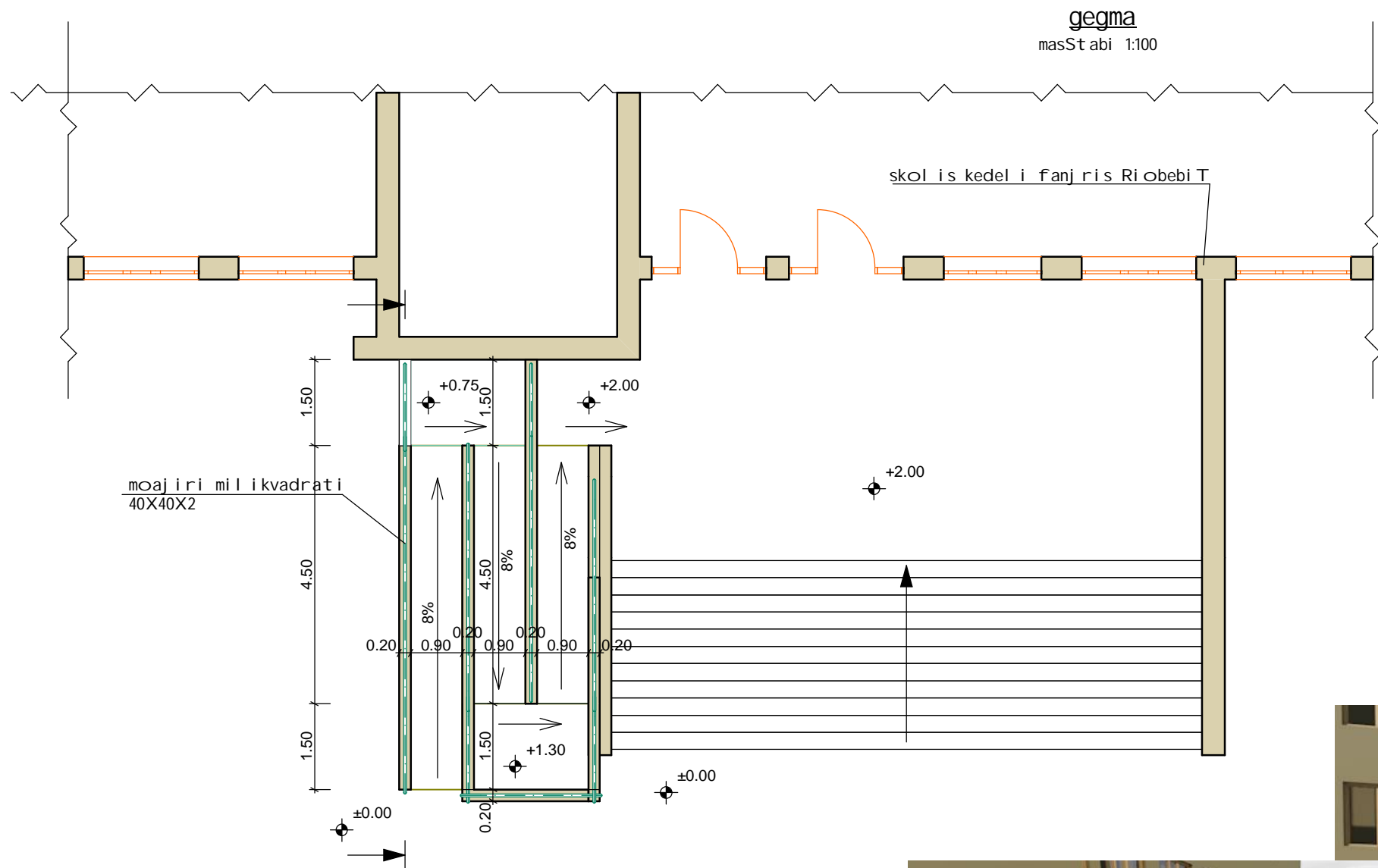

ganmartebiTi baraTi

saxel mwi fo Sesyi dvebis Sesaxeb xel Sekrul ebis (#360 20 oqtomberi 2014 q.) saFuZvel ze da xel Sekrul ebis gaTval iswnebul i momsaxurebis arweraSi mocemul i teqniki dokumentaci is CamonaTval is mi xedvi T Sedgenil i i qna q. quTai sSi CanCi baZis q. me-6 saj aro skol is ki bi sa da baqni s arsebul Ri a terasaze pandusis mowyobis samSenebl o dokumentis saproeqto-saxarj TaRricxvo dokumentaci a.

proeqti iTval iswi nebs ki bis baqni dan 3.3 metris daSorebi T paral el uri tranSeis galWras (xel iT an meqani zmi T) saZi rkvl is mosawyobad, masSi ew. "apal ovki s" Cayenebas betoni s saZi rkvl isa da mcire zomi s sayrdeni kedl ebis amoyvanas sxvadasxva ni Snul is donemde, Semdgom qvi Sa da RorRiT betoni sa da cokol is kedel Soris Sevsebas daxril obis mi saRebad, masze betoni s Sris dagebas. amasTanve gasaTval iswi nebel ia pandusis moajiris gakeTeba mil ikvadratis l iToni s el ementebi sagan romel ic Camagrdeba wi naswar betoni s kedel Si.

- _ pandusis qanobi 8%
- _ pandusis dasawyi sSi da bol oSi moedani 1.5X1.5 m.
- _ moajiris simaRl e saval i nawil idan 0.9 metri simaRl eze
- _ grZi vi Rero 0.7 metr simaRl eze (SesaZl oa 0.5 metrze)
- _ saxel urad aRebul ia mil ikvadratedebi 40X40X2 mm-ze
- _ moajiris si grZe pandusis si grZesTan Sefardebi T aRebul ia 0.3 metri T meti momrgval ebul i radiusi T
- _ moajiri Sei Rebos kontrastul i ferebi T

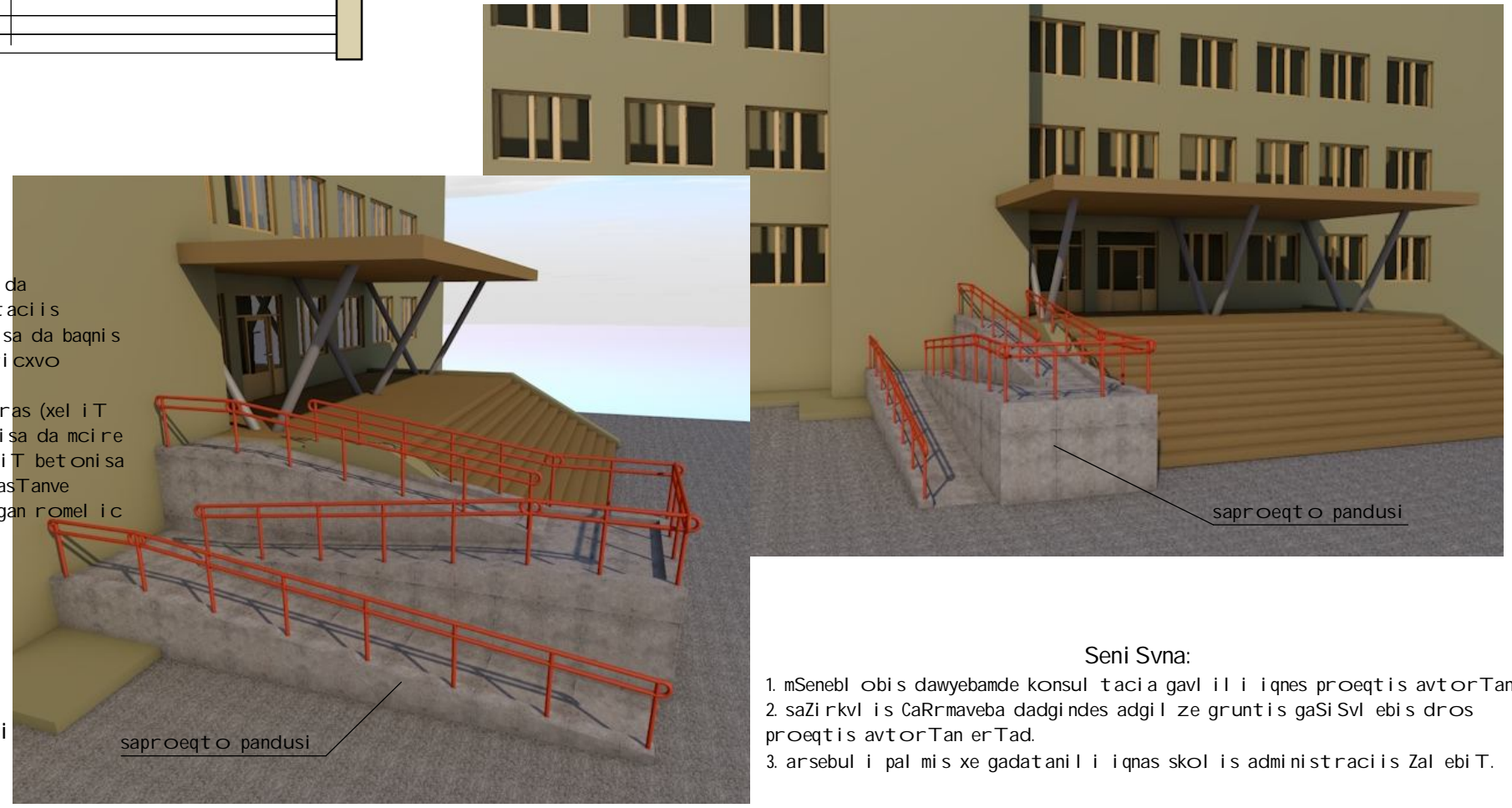

Seni Svna:

1. mSenebl obis dawyebamde konsul tacia gavil i iqnes proeqtis avtorTan.
2. saZi rkvl is CaRrmaveba dadgindes adgil ze gruntis gaSi Svl ebis dros proeqtis avtorTan erTad.
3. arsebul i pal mis xe gadatani l i iqnas skol is administraci is Zal ebis T.

	di reqtori		r. sal daZe	Sps 'pra impl ast i"	me-6 saj aro skol a (CanCi baZis)
	pr. avtori		r. sal daZe	pandusebis mowyoba	
	daamuSava		gr. yufaraZe		
				furc. a-2	

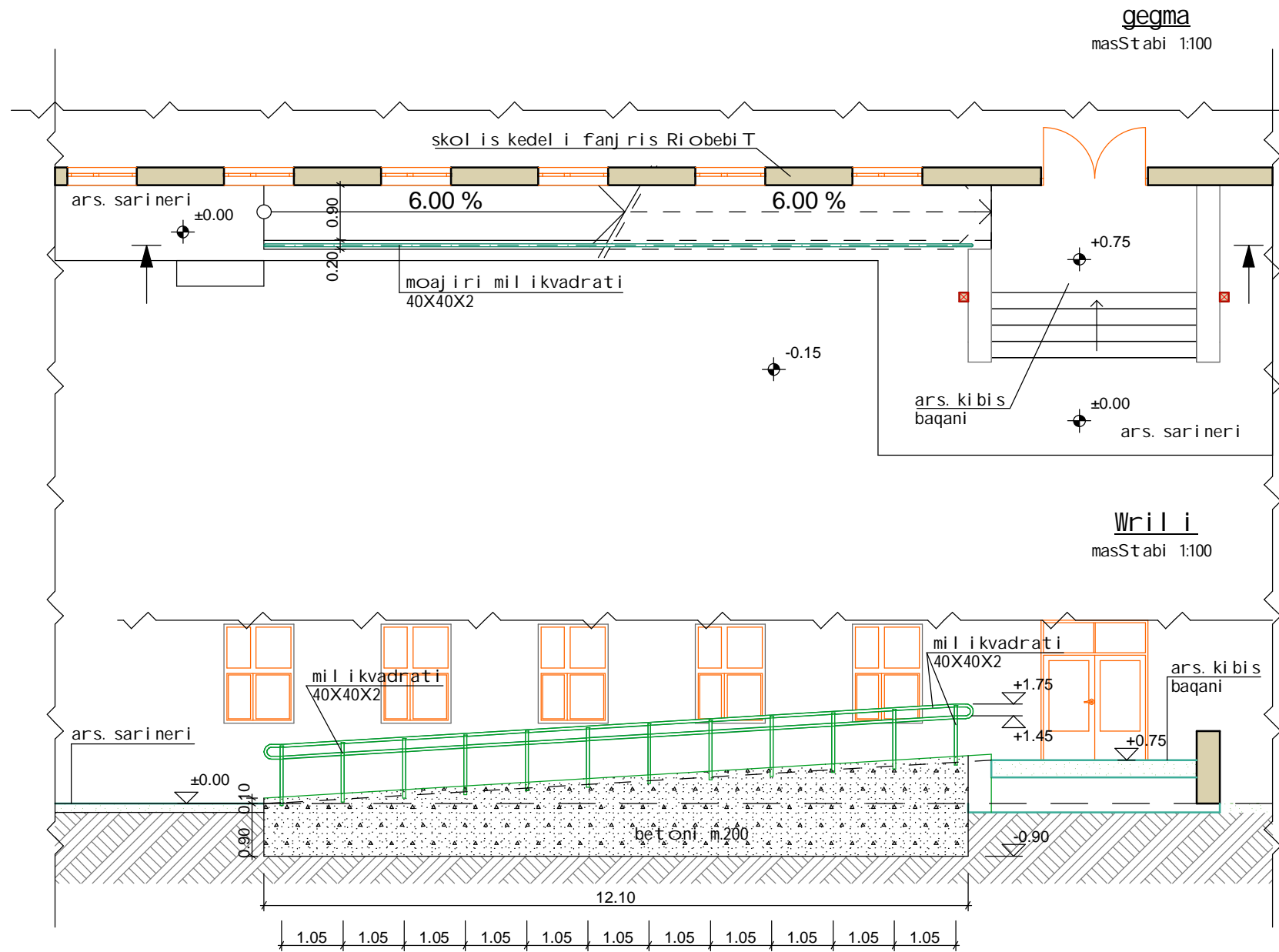

ganmartebi Ti baraTi

saxel mwi fo Sesyi dvebis Sesaxeb xel Sekrul ebis (#360 20 oqtomberi 2014 q) safuzvel ze da xel Sekrul ebis gaTval iswi nebul i momsaxurebis aRweraSi mocemul i teqnikuri dokumentaci is CamonaTval is mi xedvi T Sedgenil i iqna q. quTaisSi 31-e saj aro skol is mTavari fasadis samxreT-dasavl eT mxares kibi sa da baqni s arsebul Ri a gadmoxurul mocul obaze pandusis mowyobis samSenebl o dokumentis saproeqto-saxarj TaRricxvo dokumentacia.

proeqti iTval iswi nebs Senobis kedl idan 1.10 metris daSorebi T paral el uri tranSei s galWras (xel iT an meqani zmi T) saZi rkvl is mosawyobad, masSi qarqil is Cayenebas betonis saZi rkvl isa da mcire zomis sayrdeni kedl ebis amoyvanas sxvadasxva ni Snul is donemde, Semdgom qvi Sa da RorRi T betoni sa da cokol is kedel Soris Sevsebas daxril obis mi saRebad, masze betoni s Sris dagebas. amasTanve gasaTval iswi nebul ia pandusis moajiris gakeTeba mil ikvadratis l iToni s el ementebisagan romel ic Camagrdeba wi naswar betoni s kedel Si.

- _ pandusis qanobi 6%
- _ pandusis dasawyi sSi da bol oSi moedani 1.5X1.5 m.
- _ moajiris simaRl e saval i nawil idan 0.9 metri simaRl eze
- _ grZivi Rero 0.7 metr simaRl eze (SesaZi oa 0.5 metrze)
- _ saxel urad aRebul ia mil ikvadratebi 40X40X2 mm-ze
- _ moajiris sigrZe pandusis sigrZesTan Sefardebi T aRebul ia 0.3 metri T meti momrgval ebul i radiusi T
- _ moajiri SeiRebos kontrastul i ferebi T

Seni Svna:

1. mSenebl obis dawyebamde konsul tacia gavil i iqnes proeqtis avtorTan.
2. saZi rkvl is CaRrmaveba dadgndes adgil ze grunTis gaSi Svl ebis dros proeqtis avtorTan erTad.

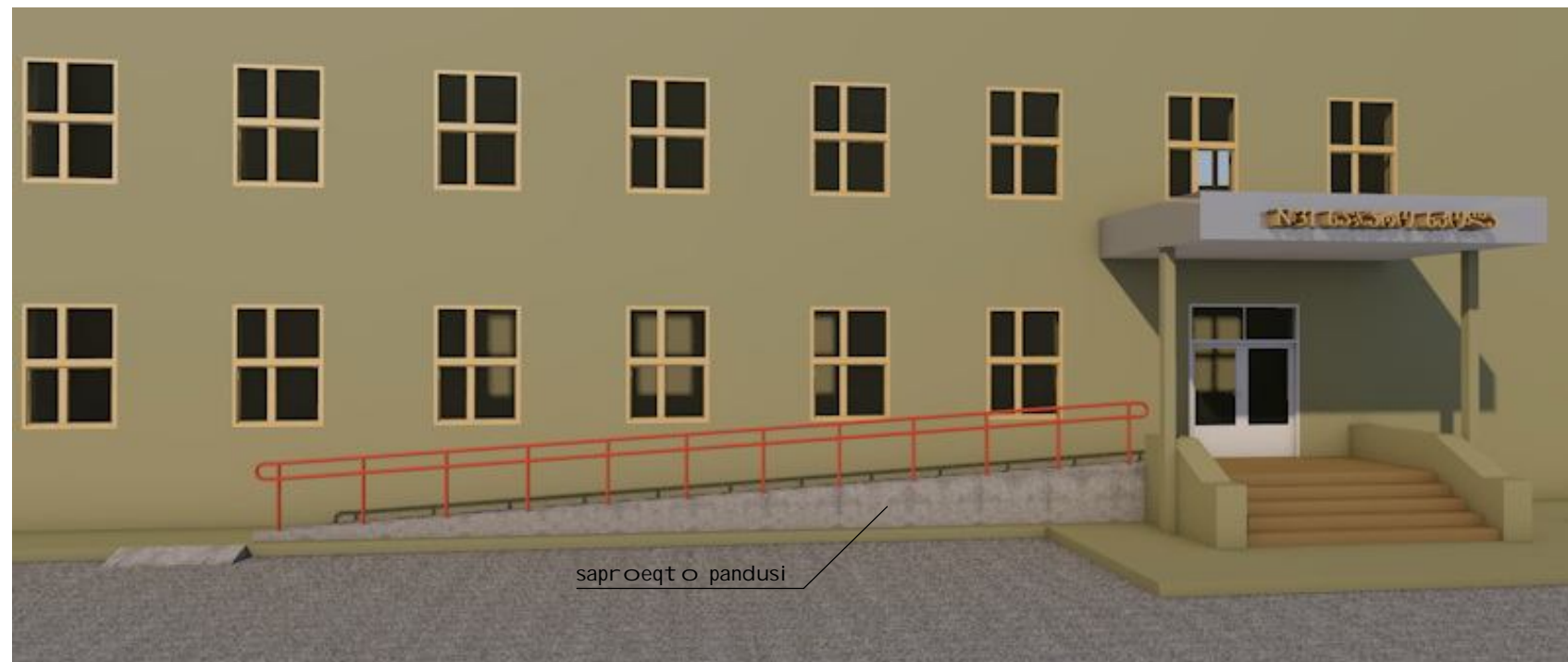

	direqtori		r. sal daZe	Sps 'pra impl ast i"	31-e saj aro skol a (xoravas quCa)
	pr. avtori		r. sal daZe	pandusebis mowyoba	
	daamuSava		gr. yufaraZe		furc. a-3

WriLi
masStabi 1:100

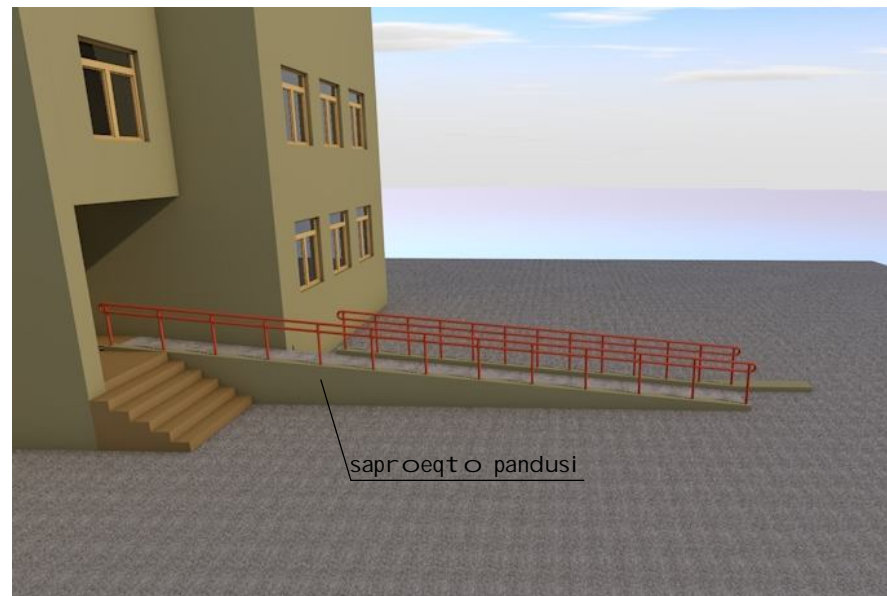
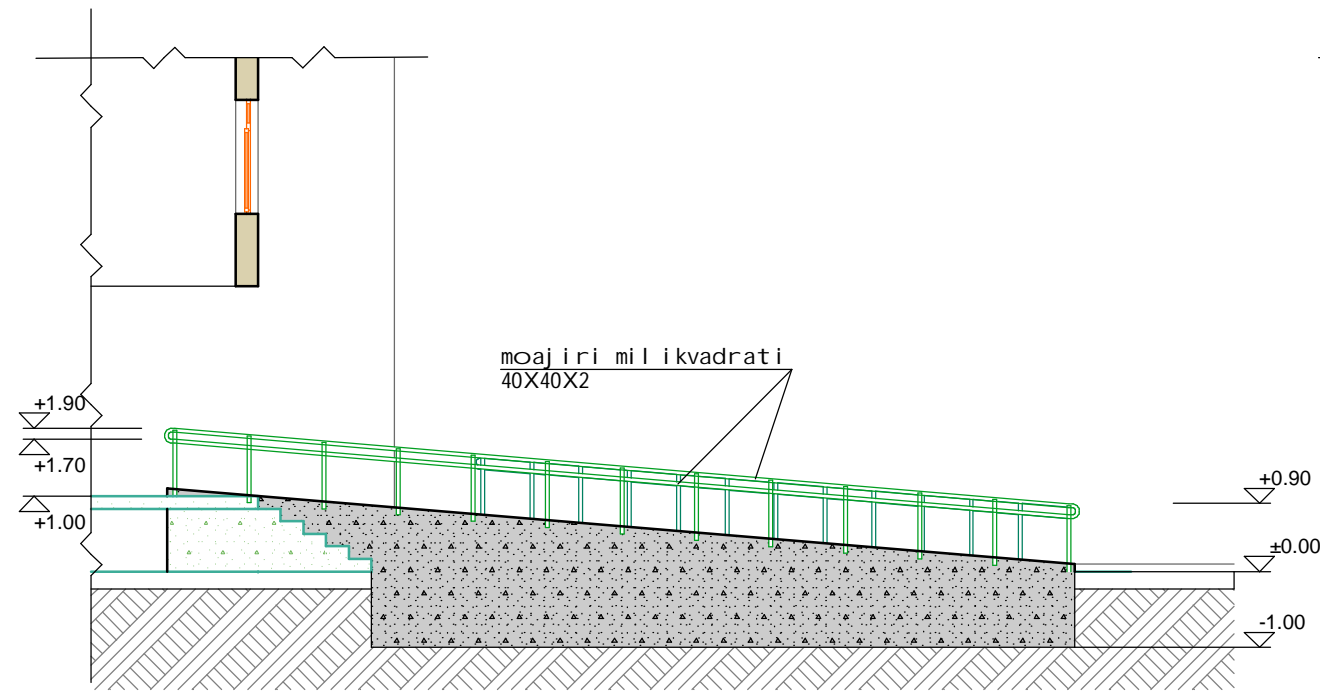

gegma
masStabi 1:100

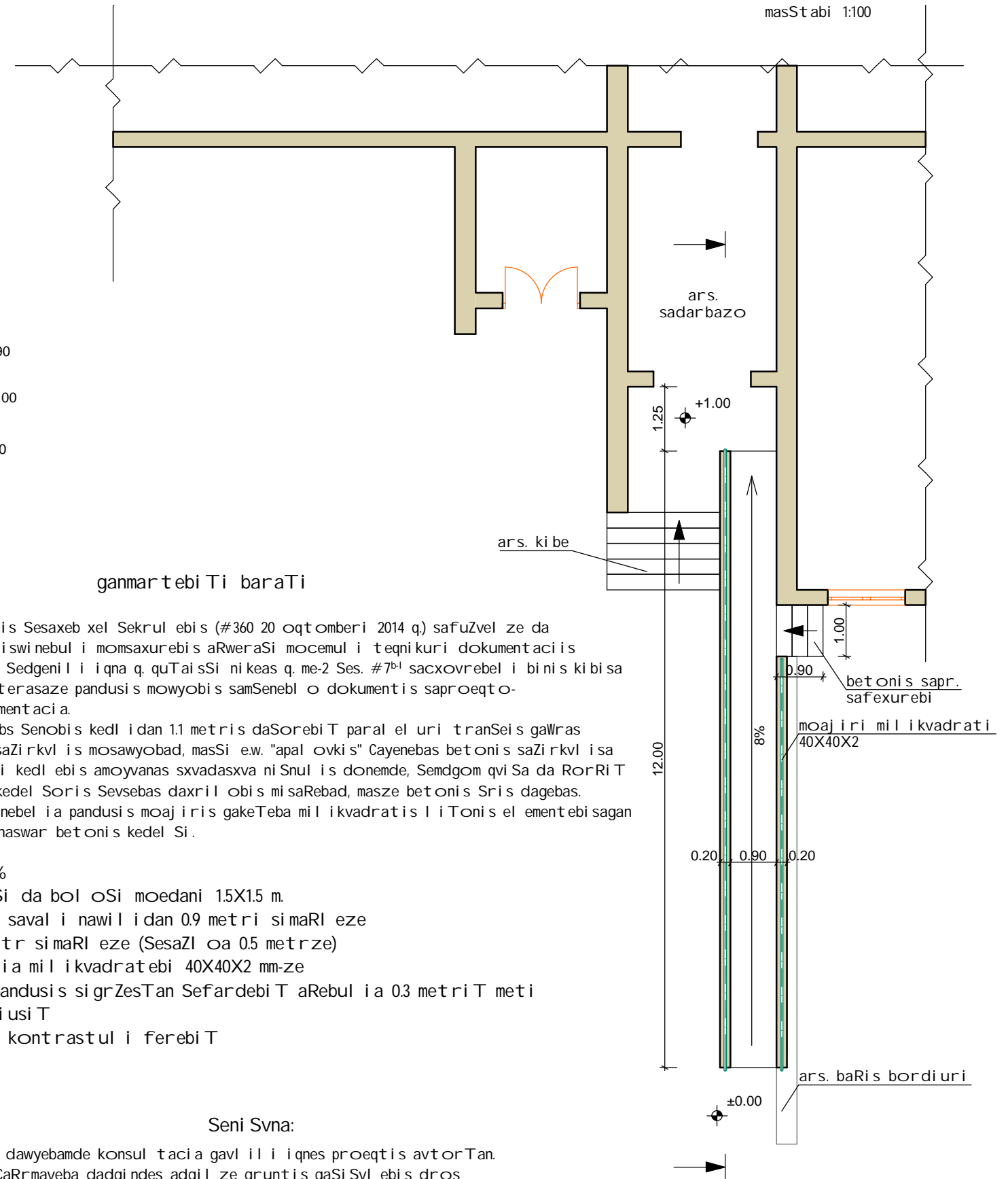

ganmar tebi Ti baraTi

saxel mwi fo Sesyi dvebis Sesaxeb xel Sekrul ebis (#360 20 oqtomberi 2014 q) safuZvel ze da xel Sekrul ebi T gaTval iswi nebul i momsaxurebis aRweraSi mocemul i teqnikuri dokumentaciis CamonaTval is mi xedvi T Sedgeni l i i qna q. quTai sSi ni keas q. me-2 Ses. #7^{b-1} sacxovrebel i bi nis ki bi sa da baqnis arsebul Ri a terasaze pandusis mowyobis samSenebl o dokumentis saproeqto-saxarj TaRricxvo dokumentaci a.

proeqti iTval iswi nebs Senobis kedl idan 1.1 metris daSorebi T paral el uri tranSeis gaWras (xel iT an meqani zmi T) saZi rkvl is mosawyobad, masSi e.w. "apal ovki s" Cayenebas betonis saZi rkvl isa da mci re zomis sayrdeni kedl ebis amoyvanas sxvadasxva ni Snul is donemde, Semdgom qvi Sa da RorRiT betoni sa da cokol is kedel Soris Sevsebas daxril obis mi saRebad, masze betonis Sris dagebas. amasTanve gasaTval iswi nebel ia pandusis moajiris gakeTeba mil ikvadratis l iTonis el ementebi sagan romel ic Camagrdeba wi naswar betonis kedel Si.

- _ pandusis qanobi 8%
- _ pandusis dasawyi sSi da bol oSi moedani 1.5X1.5 m.
- _ moajiris simaRI e savali nawil idan 0.9 metri simaRI eze
- _ grZivi Rero 0.7 metr simaRI eze (SesaZl oa 0.5 metrze)
- _ saxel urad aRebul ia mil ikvadratedebi 40X40X2 mm-ze
- _ moajiris sigrZe pandusis sigrZesTan Sefardebi T aRebul ia 0.3 metri T meti momrgval ebul i radiusi T
- _ moajiri SeiRebos kontrastul i ferebi T

Seni Svna:

1. mSenebl obis dawyebamde konsul tacia gavli l i iqnes proeqtis avtorTan.
2. saZi rkvl is CaRrmaveba dadgindes adgil ze gruntis gaSi Svl ebis dros proeqtis avtorTan erTad.

	di reqtori		r. sal daZe	Sps 'pra impl ast i"	ni kesa quCa me-2 Ses. #7 ^{b-1}
	pr. avtori		r. sal daZe	pandusebis mowyoba	
	daamuSava		gr. yufaraZe		furc. a-4

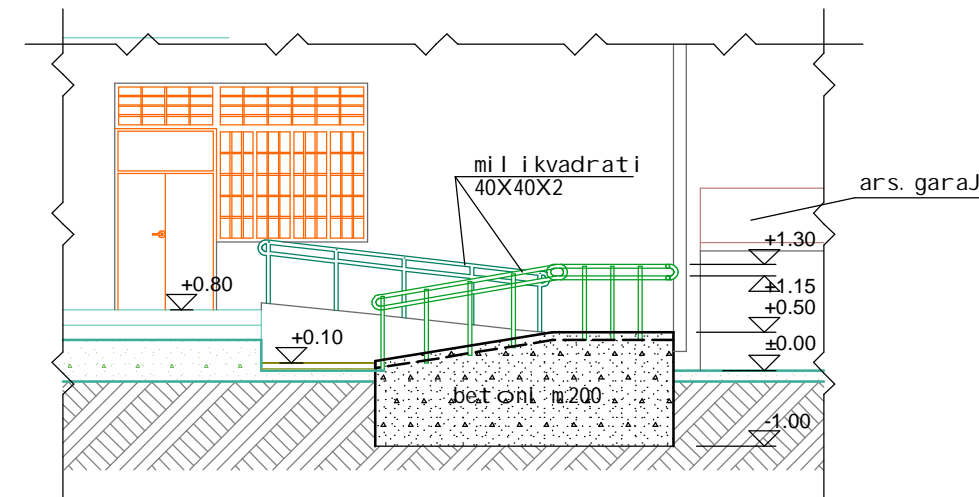
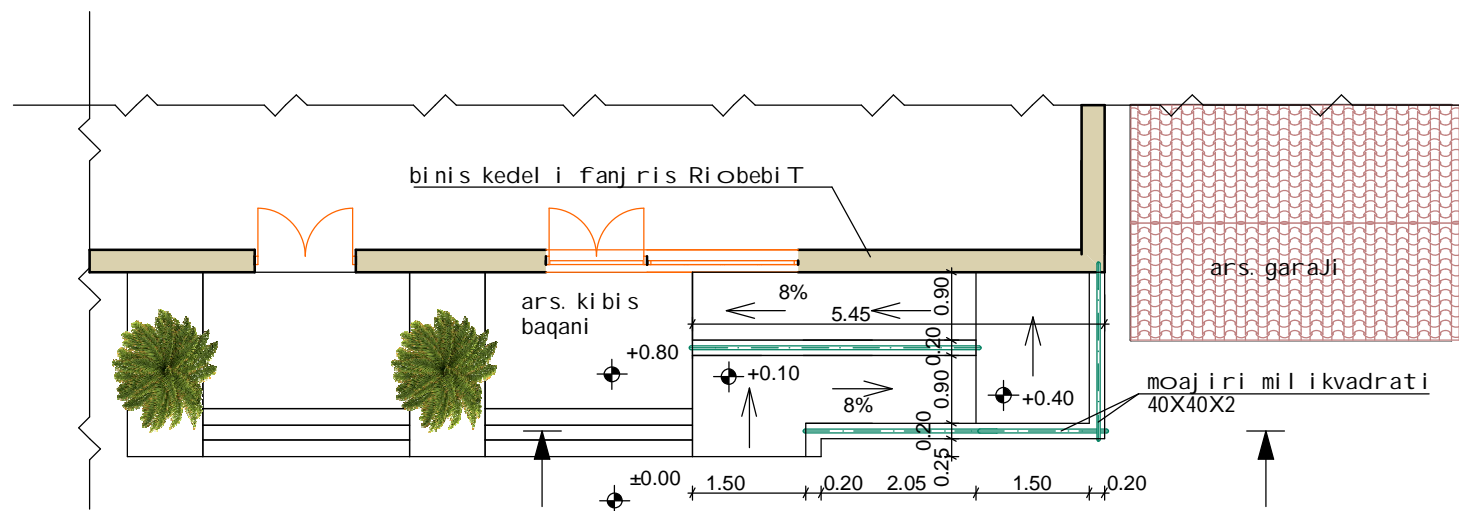

ganmartebi Ti baraTi

saxel mwi fo Sesydvebi s Sesaxeb xel Sekrul ebis (#360 20 oqtomberi 2014 q) safuzvel ze da xel Sekrul ebi T gaTval iswi nebul i momsaxurebis arweraSi mocemul i teqnikuri dokumentacis CamonaTval is mi xedvi T Sedgenil i iqna q. quTai sSi buxai Zi s q. #4 (Cr dil oeTi mxare) kibi sa da baqni s arsebul Ri a terasaze pandusi s mowyobi s samSenebl o dokumentis saproeqto-saxarj TaRri cxvo dokumentacia.

proeqti iTval iswi nebs arsebul i Senobis kedl idan 22 metris daSorebi T paral el uri tranSeis gaWras (xel iT an meqani zmi T) saZi rkvl is mosawyobad, masSi qarqil is Cayenebas betonis saZi rkvl is da mci re zomi s sayrdeni kedl ebis amoyvanas sxvadasxva ni Snul is donemde, Semdgom qvi Sa da RorRiT betonisa da cokol is kedel Soris Sevsebas daxril obis mi saRebad, masze betonis Sris dagebas. amasTanve gasaTval iswi nebel ia pandusi s moajiri s gakeTeba mi li kvadrat is li Toni s el ementebi sagan romel ic Camagrdeba wi naswar betonis kedel Si.

- _ pandusi s qanobi 8%
- _ pandusi s dasawyi sSi da bol oSi moedani 1.5X1.5 m.
- _ moajiri s simaRl e saval i nawil idan 0.9 metri simaRl eze
- _ grZivi Rero 0.7 metr simaRl eze (SesaZl oa 0.5 metrze)
- _ saxel urad aRebul ia mi li kvadratebi 40X40X2 mm-ze
- _ moajiri s si grZe pandusi s si grZesTan Sefardebi T aRebul ia 0.3 metri T meti momrgval ebul i radiusi T
- _ moajiri SeiRebos kontrastul i ferebi T

Seni Svna:

1. mSenebl obis dawyebamde konsul tacia gavli li iqnes proeqtis avtorTan.
2. saZi rkvl is CaRrmaveba dadgindes adgil ze grunTis gaSi Svl ebis dros proeqtis avtorTan erTad.

	di reqtori		r. sal daZe	Sps 'pra impl ast i"	buxai Zi s quCa #4 Cr dil oeTi mxare
	pr. avtori		r. sal daZe	pandusebis mowyoba	
	daamuSava		gr. yufaraZe		
				furc. a-5	

WriLi
masStabi 1:100

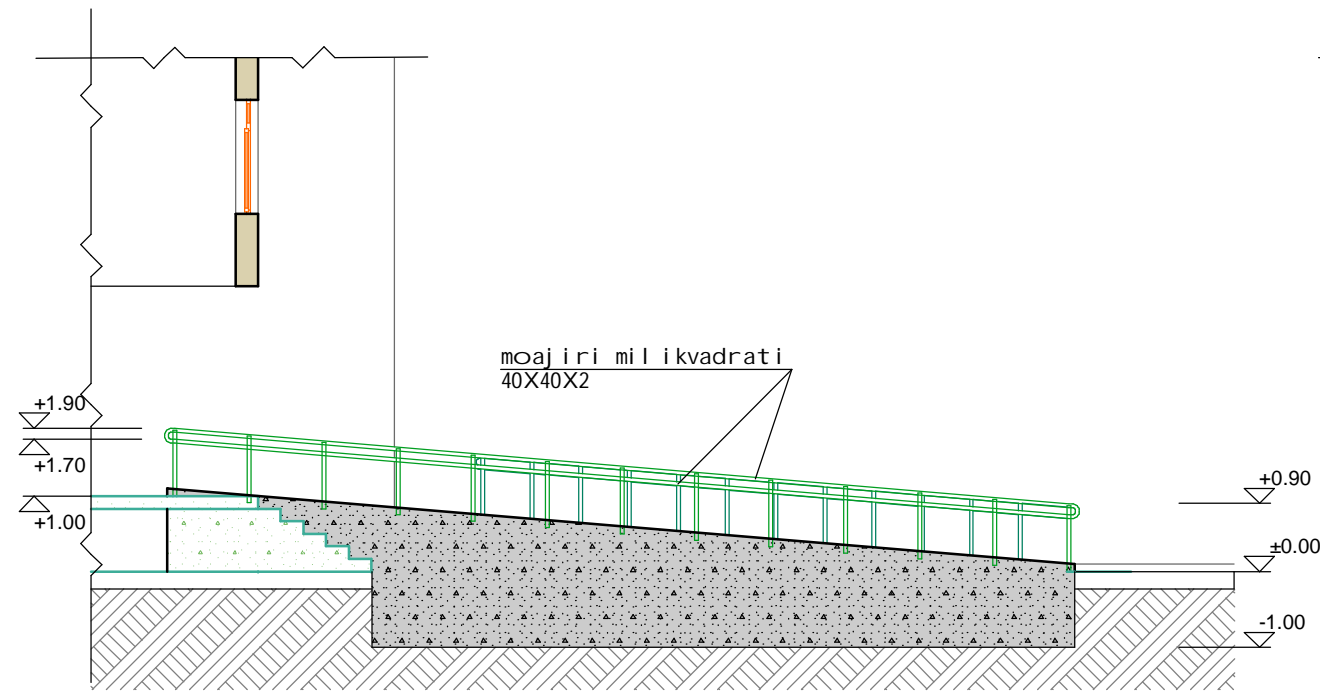

gegma
masStabi 1:100

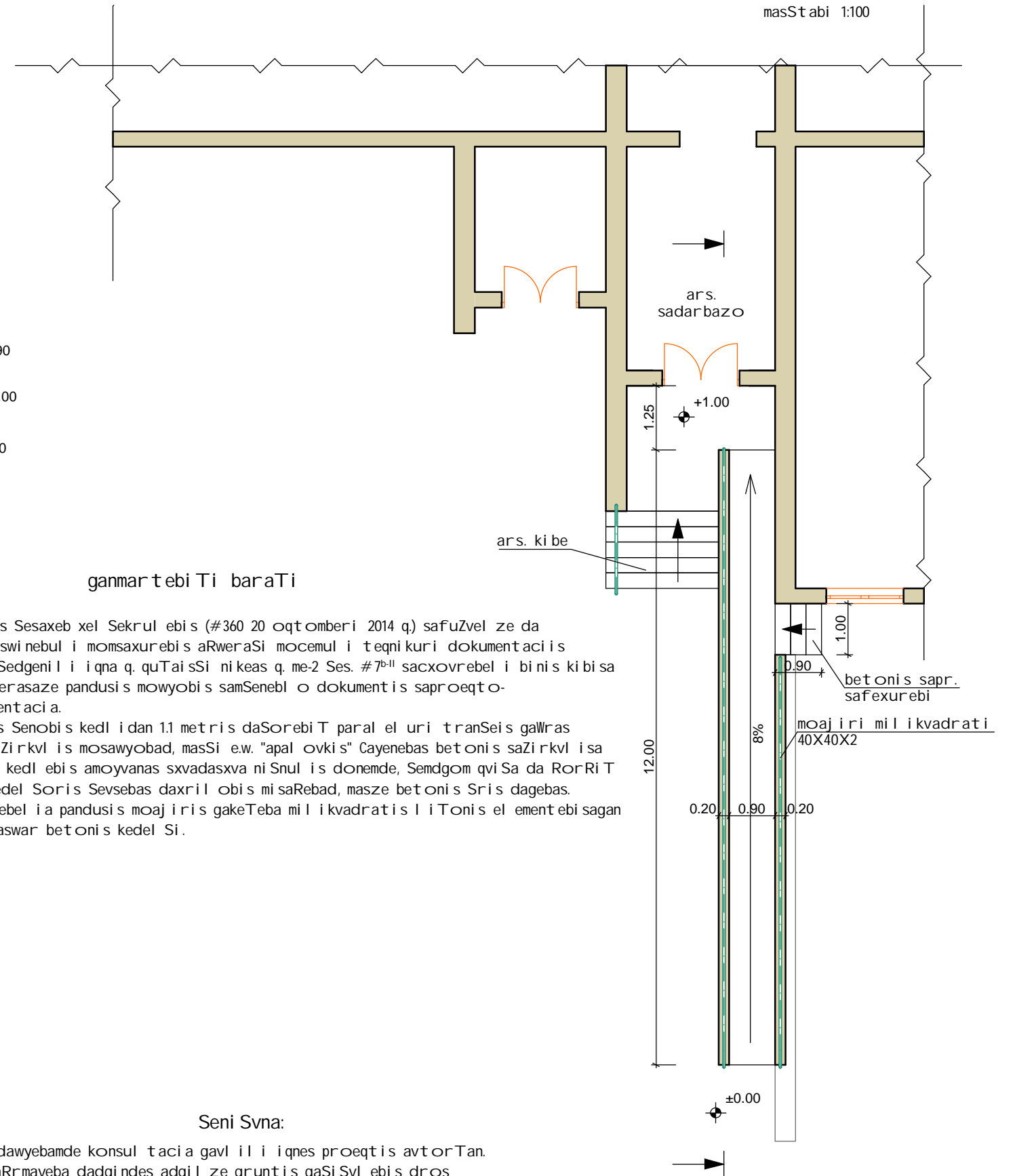

ganmar tebi Ti baraTi

saxel mwi fo Sesyi dvebi s Sesaxeb xel Sekrul ebi s (#360 20 oqtomberi 2014 q) safuZvel ze da xel Sekrul ebi T gaTval i swi nebul i momsaxurebi s aRweraSi mocemul i teqni kuri dokumentaci s CamonaTval is mi xedvi T Sedgeni l i i qna q. quTai sSi ni keas q. me-2 Ses. #7^{b-II} saxovrebel i bi ni s ki bi sa da baqni s arsebul Ri a terasaze pandusi s mowyobi s samSenebl o dokument is saproeqto-saxarj TaRri cxvo dokumentaci a.

proeqti iTval i swi nebs Senobi s kedl i dan 1.1 metris daSorebi T paral el uri tranSeis galWras (xel iT an meqani zmi T) saZi rkv l is mosawyobad, masSi e.w. "apal ovki s" Cayenebas beton is saZi rkv l isa da mci re zomi s sayrdeni kedl ebi s amoyvanas sxvadasxva ni Snul is donemde, Semdgom qvi Sa da RorRi T beton is a da cokol is kedel Soris Sevsebas daxril obis mi saRebad, masze beton is Sris dagebas. amasTanve gasaTval i swi nebul ia pandusi s moajiri s gakeTeBa mil ikvadratis l iToni s el ement ebi sagan romel i c Camagrdeba wi naswar beton is kedel Si.

Seni Svna:

1. mSenebl obis dawyebamde konsul tacia gavli l i iqnes proeqtis avtorTan.
2. saZi rkv l is CaRrmaveba dadgindes adgil ze grunt is gaSi Svl ebi s dros proeqtis avtorTan erTad.

	di reqtori		r. sal daZe	Sps 'pra impl ast i"	ni kesa quCa me-2 Ses. #7 ^{b-II}
	pr. avtori		r. sal daZe	pandusebi s mowyoba	
	daamuSava		gr. yufaraZe		furc. a-6